



Brewing & Applying Compost Tea

Brewing



Step 1

Step 1: Fill the stocking with compost.

Step 2: Fill the bucket with water. If you have chlorinated water allow the water to sit for 24 hours so the chlorine can evaporate.

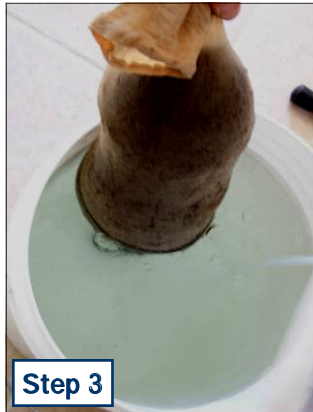

Step 3

Step 3: Submerge bag of compost in water.



Step 4

Step 4: Sink tubing and attached stone to bottom of bucket.



Step 5

Step 5: Connect tube to aerator and turn on pump.



Step 6

Step 6: Aerate for 24-36 hours.

Step 7: Mix in 1 tbsp. of molasses 2 hours before applying.

Applying



Step 1

Step 1: Attach siphon to outdoor faucet.



Step 2

Step 2: Sink black siphon tube to bottom of bucket.



Step 3

Step 3: Attach garden hose to siphon and spray.

NOTE:
Only 1 quart of compost tea is needed to cover a 1,000 square foot lawn!